

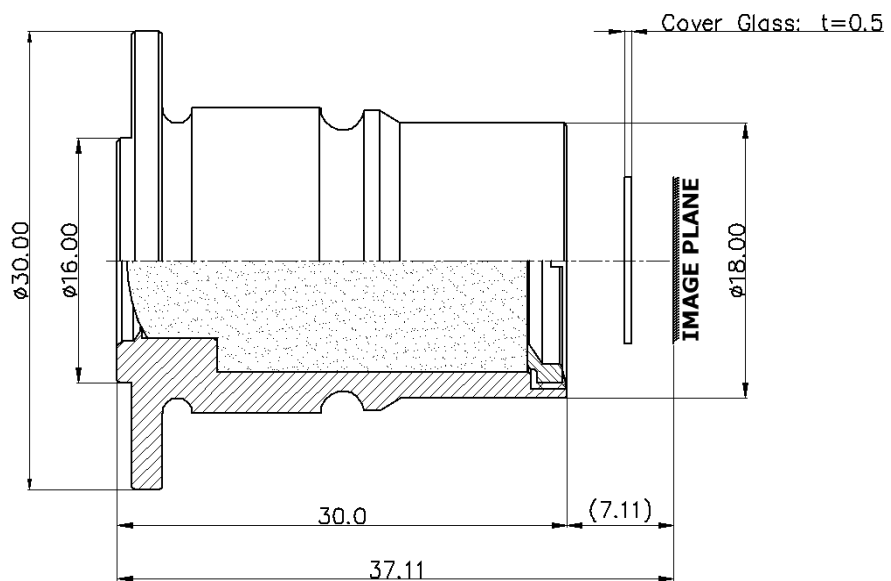

170628CM-3M

Application		Mashine Vision
Focal Length		17.0mm
F No.		2.8
Iris		Fixed
MAX Image Circle Diameter		Φ 11.0
Sensing Area		2/3"
Object Distance		342.97mm
Flange Back Length		7.11mm
Back Focal Length		12.1mm
Total Track Length		37.11mm
Optical Distortion		-2.08%
Angle of View	Diagonal	35.67°
	Horizontal	28.68°
	Vertical	21.58°
Chief Ray Angle(1.0F)		10.86°
Relative Illumination(1.0F)		91.3%
M.O.D		1357cm - ∞
Resolution [@100lp/mm]	On-Axis	54.8%
	0.7 Field	(S)47.5%/(T)65.7%
Wavelength		Visible (Blue, 452nm)
Filter		Band pass Filter: 452nm (T>93%)
Waterproof		-



Tolerance: ± 0.4